

Model	Rated Voltage	No Load		Rated Load			Direction	Length (l)
		Current	Speed	Load	Current	Speed		
	Vdc	mA	min ⁻¹	mN·m	mA	min ⁻¹		
A 125	0.5	30	750	0.1	50	620	CW	12.1
A 114	1.2	110	6700	0.6	470	5600	CW	6.4
A 231	2.4	45	5000	0.5	150	4300	CCW	12.1
A 229	3.0	20	3000	0.3	60	2600	CW	12.1
A 330	6.0	8	2600	0.15	14	2400	CW	7.6
A 423	12.0	9	6000	1.5	100	4000	CW	5.4

軸受台 φ 4.8
タップ間 11.0

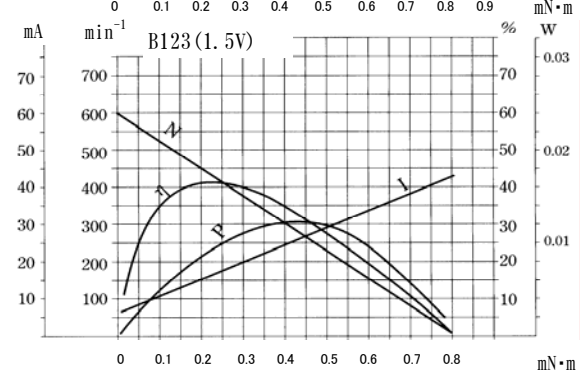

Model	Rated Voltage	No Load		Rated Load			CW	l	C
		Current	Speed	Load	Current	Speed			
	Vdc	mA	min ⁻¹	mN·m	mA	min ⁻¹			
B125	0.4	16	300	0.1	27	250		13.9	5.5
B132	0.4	16	300	0.1	22	260		10.7	4.5
B132	1.5	20	1300	0.2	40	1200		10.7	4.5
B123	1.5	6	550	0.2	15	450		13.9	4.5 (l) 7.2

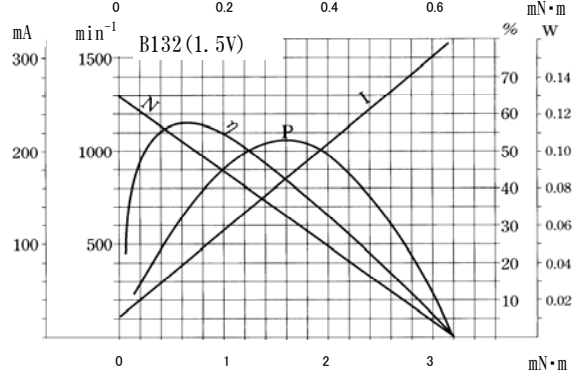
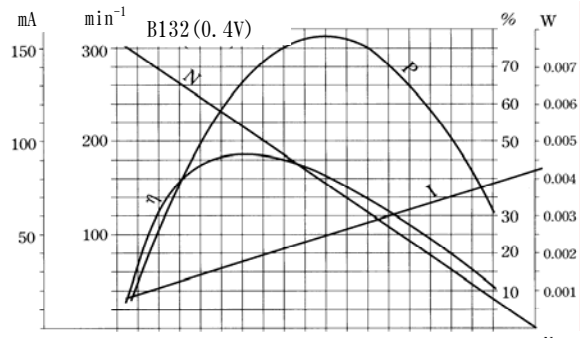
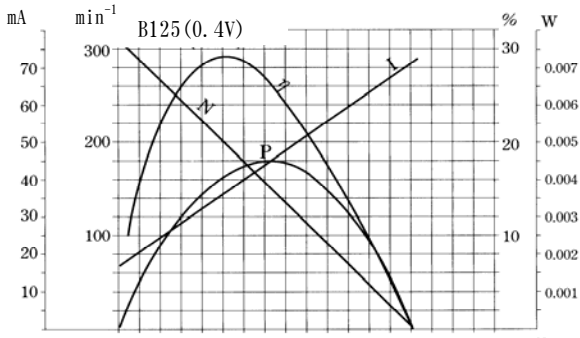
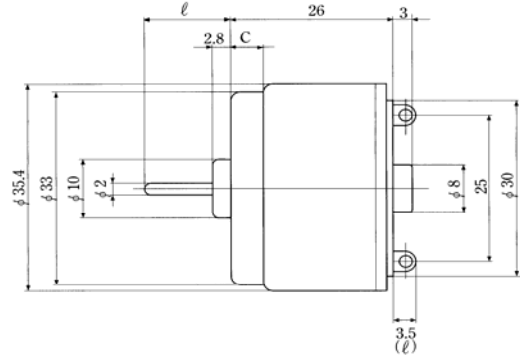
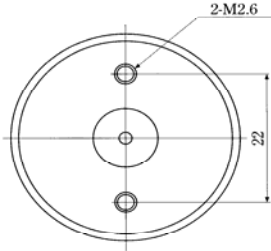
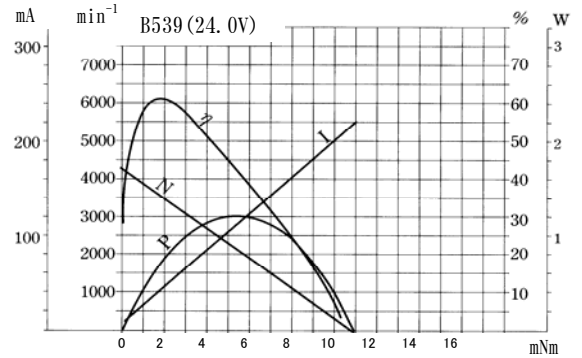
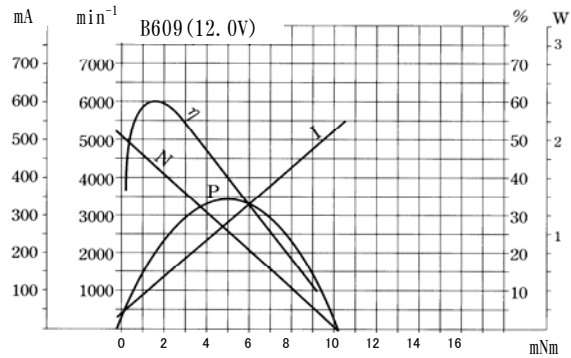
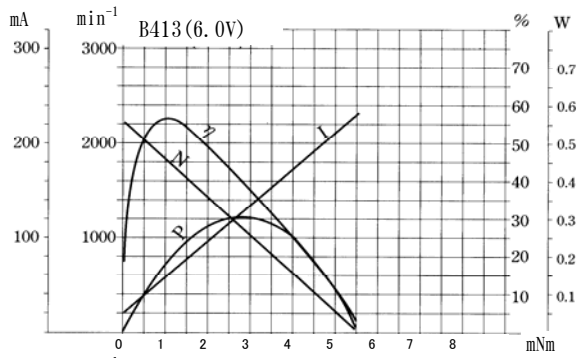
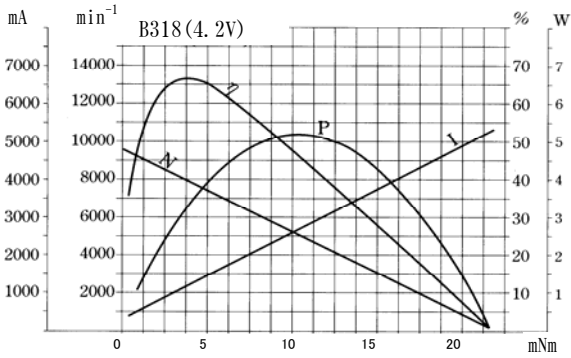
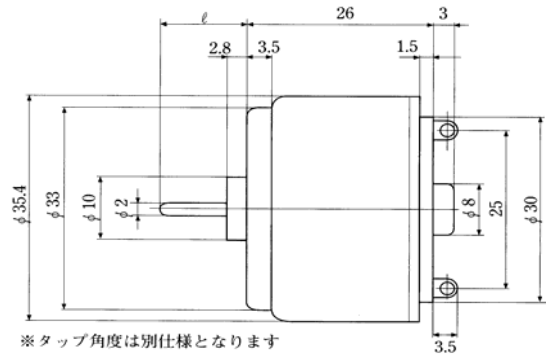
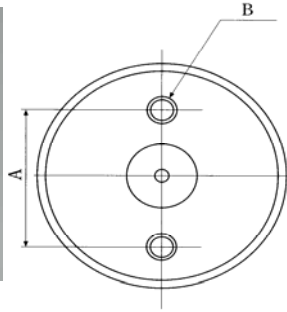

Model	Rated Voltage	No Load		Rated Load			CW	ℓ	A B
		Current	Speed	Load	Current	Speed			
	V _{dc}	mA	min ⁻¹	mNm	mA	min ⁻¹			
B116	1.2	120	3800	1.5	600	3200		6.6	²³ M3
B318	4.2	230	10000	4.0	1200	8000		18.8	²³ M3
B413	6.0	14	2200	1.0	54	1800		8.8	²⁶ M2.6 ※
B609	12.0	20	5200	1.0	70	4700		8.8	²³ M3
B539	24.0	10	4400	1.0	30	4000		6.6	²⁶ M2.6 ※

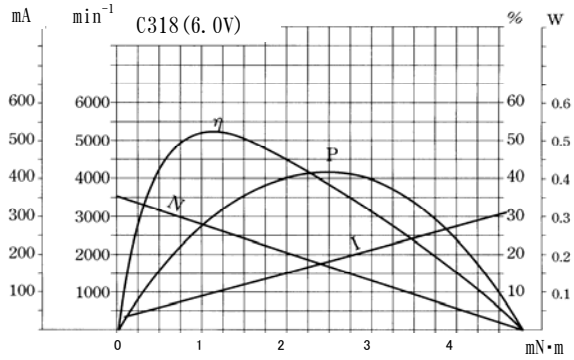
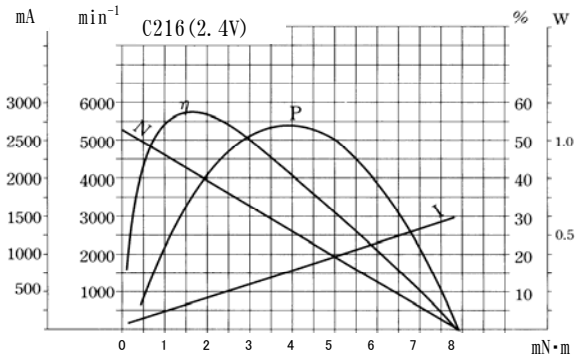
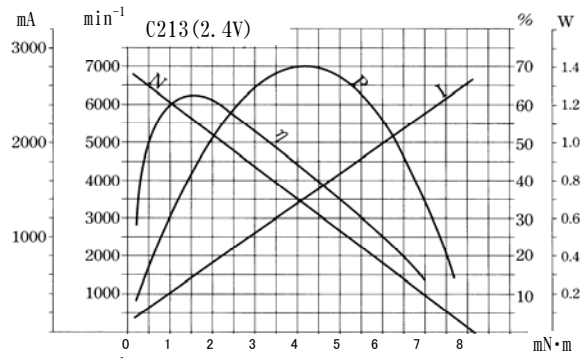
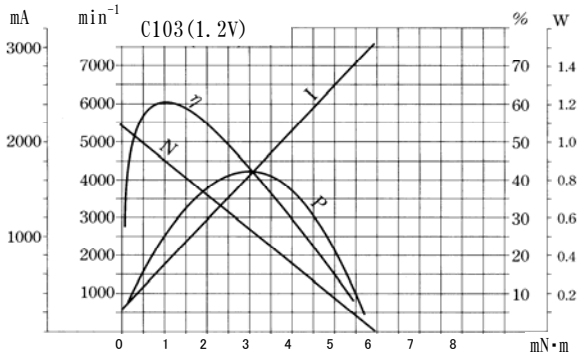
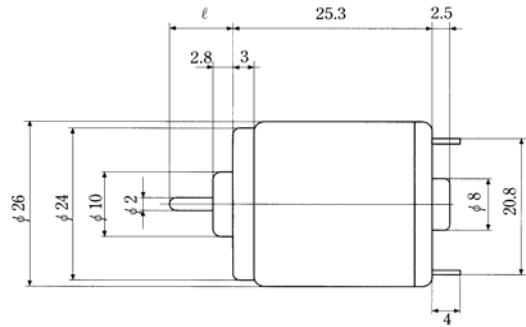
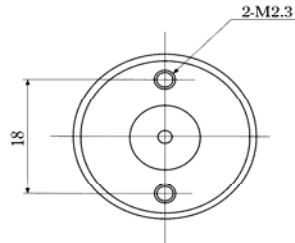

Model	Rated Voltage	No Load		Rated Load			CW	ℓ
		Current	Speed	Load	Current	Speed		
	V _{DC}	mA	min ⁻¹	mN·m	mA	min ⁻¹		
C103	1.2	160	5400	1.0	640	4500	CW	8.8
C213	2.4	120	6800	1.3	520	5700	CW	8.8
C216	2.4	130	5500	0.8	320	4900	CW	8.8
C318	6.0	35	3600	1.0	100	2700	CW	12.5

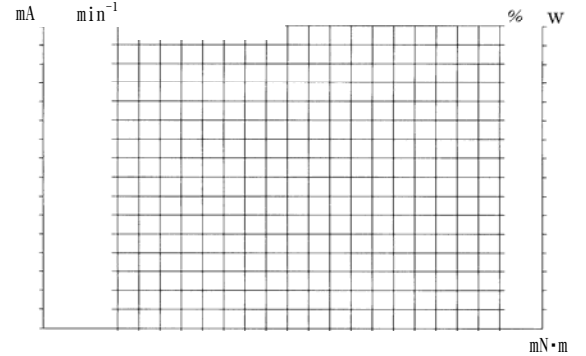
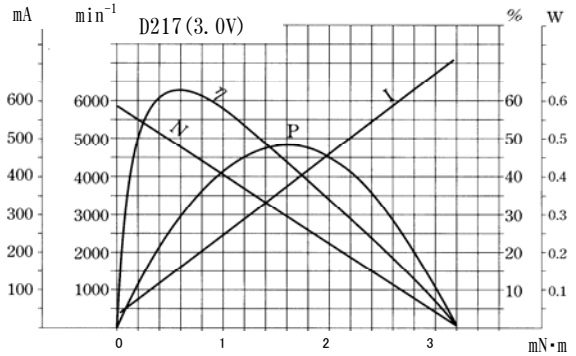
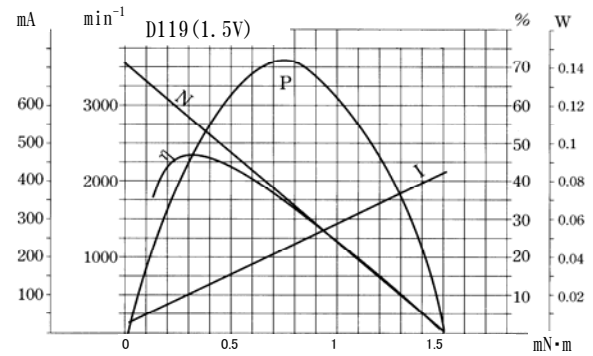
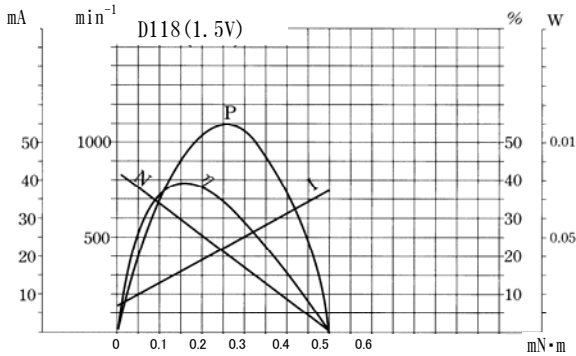
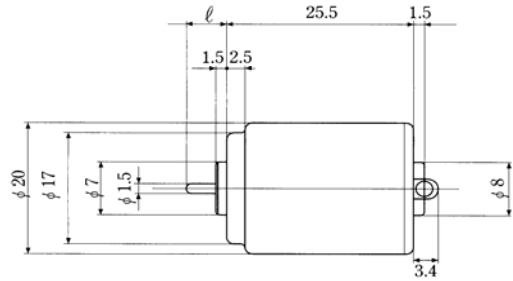
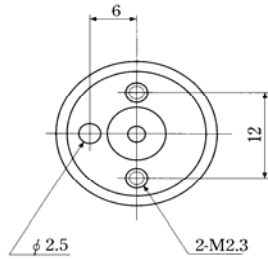

Model	Rated Voltage	No Load		Rated Load				
		Current	Speed	Load	Current	Speed		
	VDC	mA	min ⁻¹	mN·m	mA	min ⁻¹	ℓ	
D118	1.5	7	800	0.1	13	650	CW	5.5
D119	1.5	45	3600	0.2	100	3100	CW	5.5
D217	3.0	33	6200	0.5	140	5100	CW	5.5
D221	3.0	45	4700	0.6	170	2750	CW	6.3

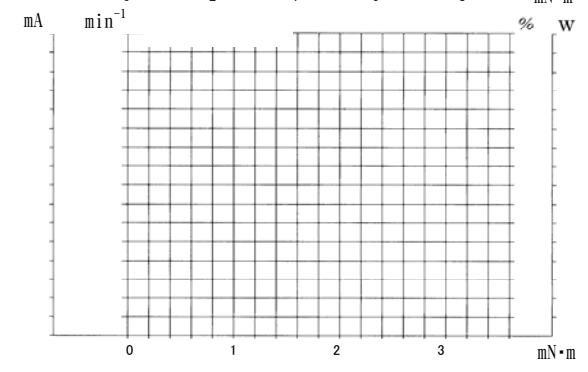
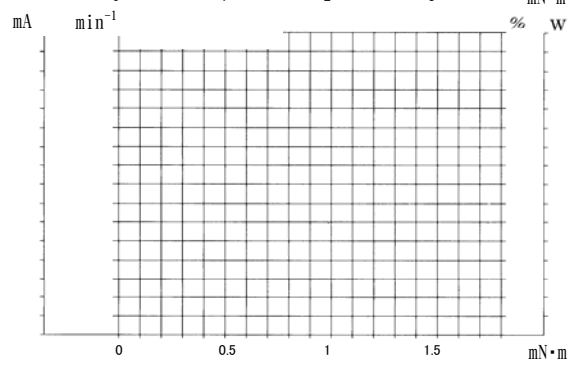
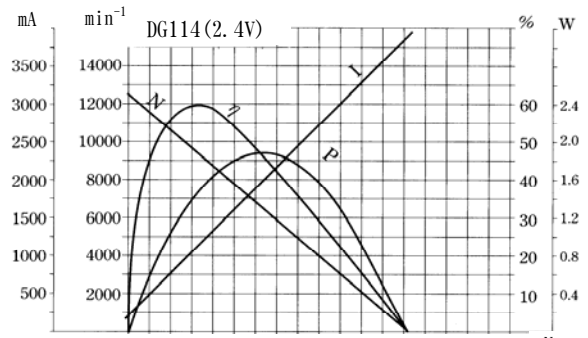
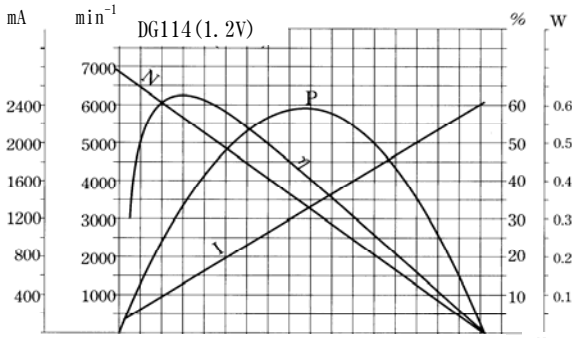
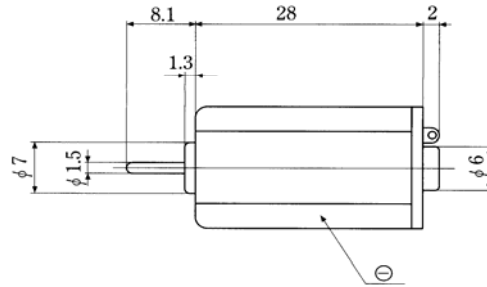
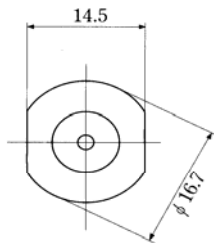

Model	Rated Voltage	No Load		Rated Load			CW
		Current	Speed	Load	Current	Speed	
	V _{dc}	mA	min ⁻¹	mN·m	mA	min ⁻¹	
DG114	1.2	80	6900	0.7	500	5600	CW
DG114 _{タイプ}	2.4	100	12800	0.7	600	11000	CW

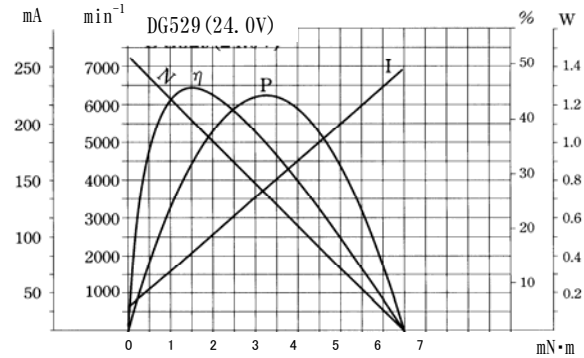
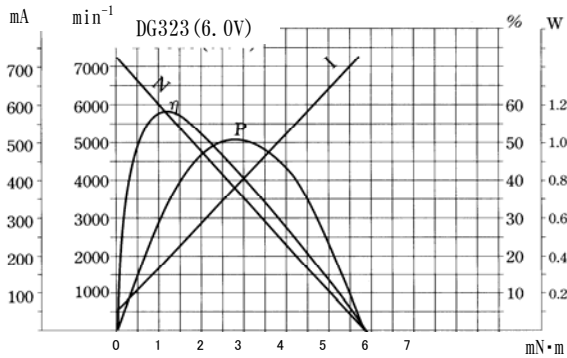
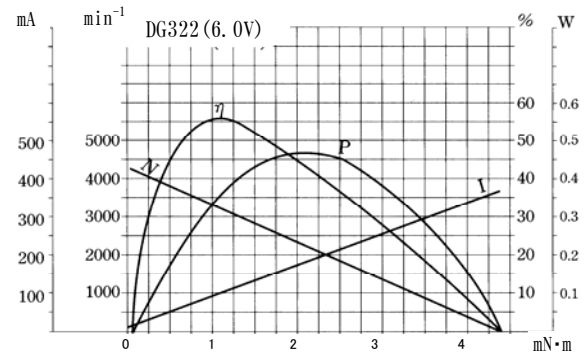
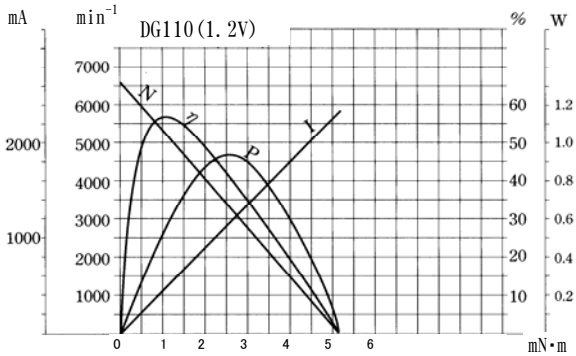
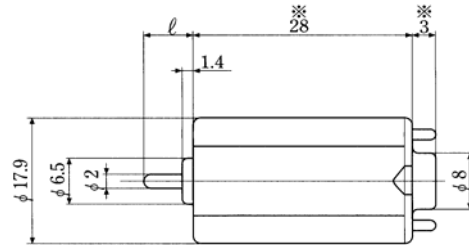
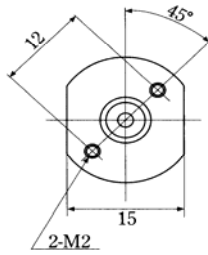

Model	Rated Voltage	No Load		Rated Load			CW	ℓ	タップ°ナシ
		Current	Speed	Load	Current	Speed			
	V _{DC}	mA	min ⁻¹	mN·m	mA	min ⁻¹			
DG110	1.2	200	6500	0.8	640	5000	16.3		
DG322	6.0	40	4400	0.65	80	3700	6.3		
DG323	6.0	100	7200	1.5	240	5200	10.3		
DG424	12.0	40	7000	1.5	150	5200	7.9		
DG526	24.0	80	14500	2.0	230	12300	12.0	28→29 3→3.5	
DG529	24.0	30	7200	2.0	120	5000	13.4	28→29 3→3.5	

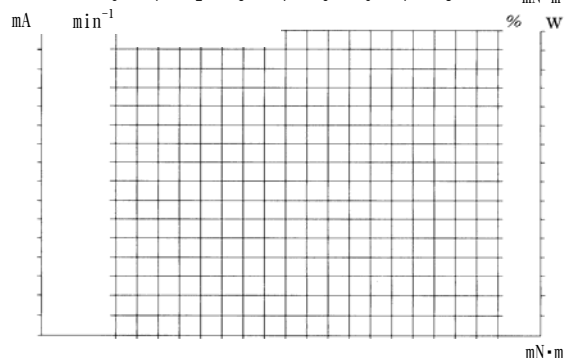
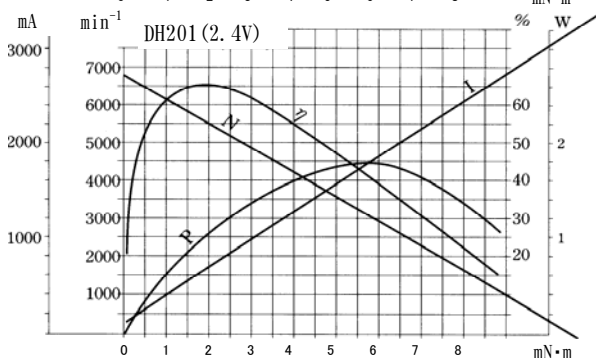
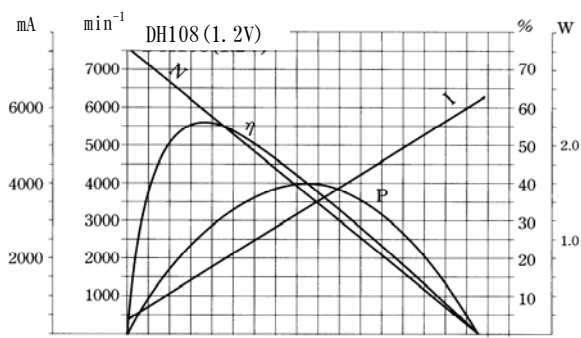
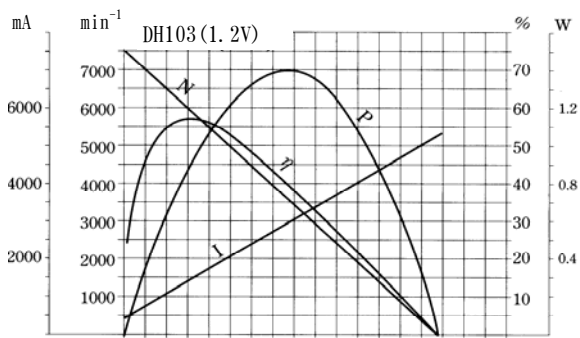
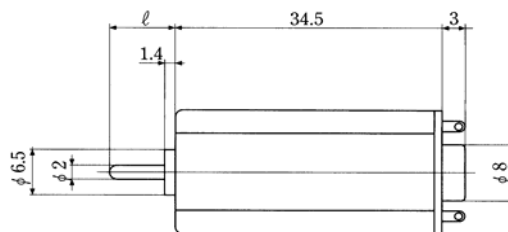
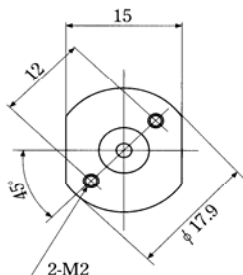

Model	Rated Voltage	No Load		Rated Load					
		Current	Speed	Load	Current	Speed	ℓ		
	V _{dc}	mA	min ⁻¹	mN·m	mA	min ⁻¹			
DH103	1.2	310	7400	0.8	830	6600	CW	9.8	
DH108	1.2	330	7800	0.8	900	7050	CW	9.8	
DH201	2.4	120	6900	1.5	560	5800	CCW	8.0	Dカット軸
DH345	5.0	60	4150	1.0	150	3400	CCW	9.8	

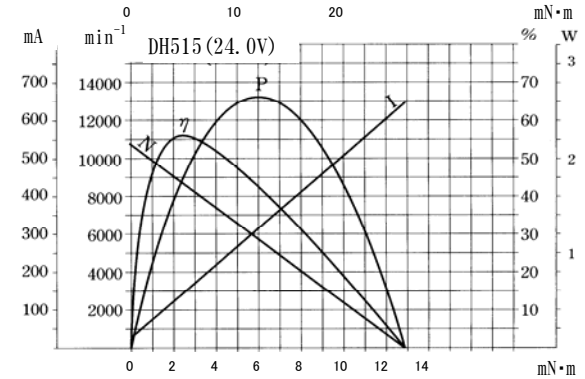
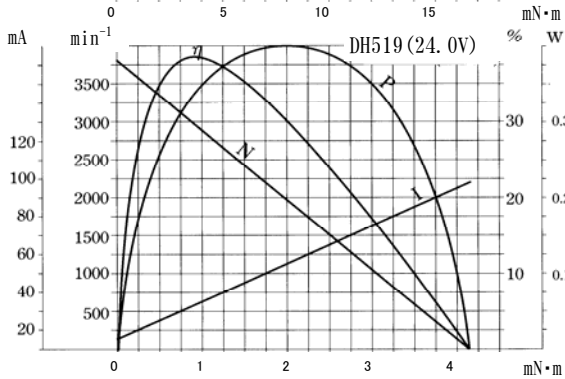
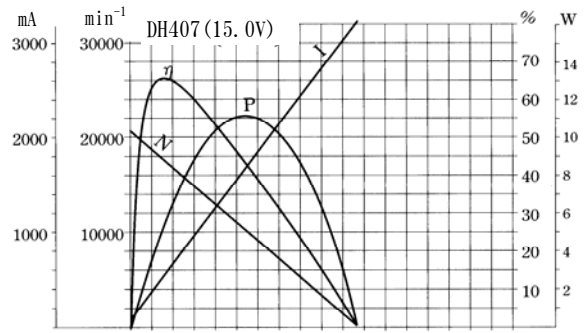
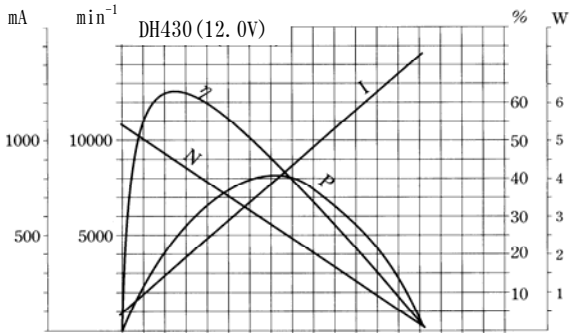
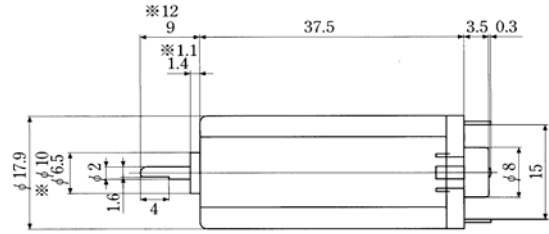
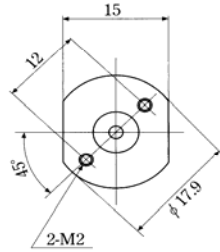

Model	Rated Voltage	No Load		Rated Load			Rotation Direction	Notes
		Current	Speed	Load	Current	Speed		
	VDC	mA	min ⁻¹	mN·m	mA	min ⁻¹		
DH430	12.0	100	10500	4.5	580	7400	CW	
DH407	15.0	130	20000	1.0	300	19500	CW	丸軸 タップナシ
DH519	24.0	20	3700	1.5	45	2400	CW	Dカット 4→3.5
DH515	24.0	45	10500	2.5	200	8600	CW	

※

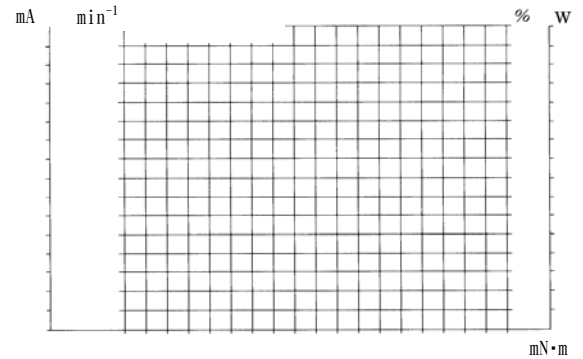
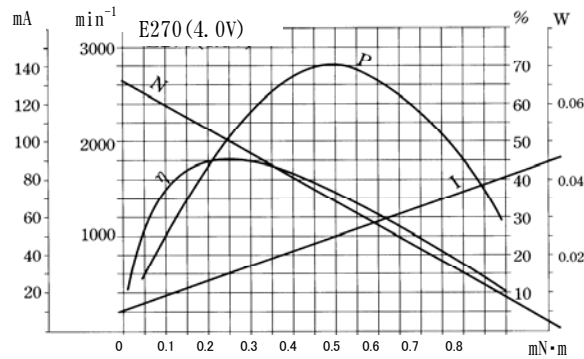
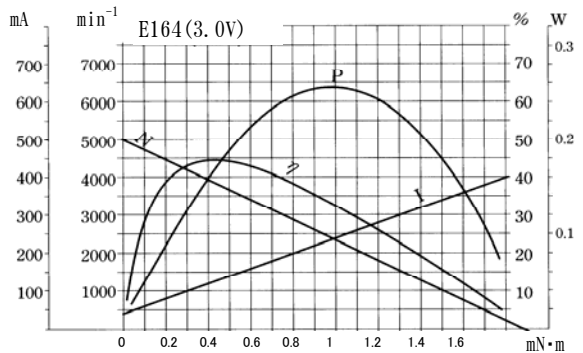
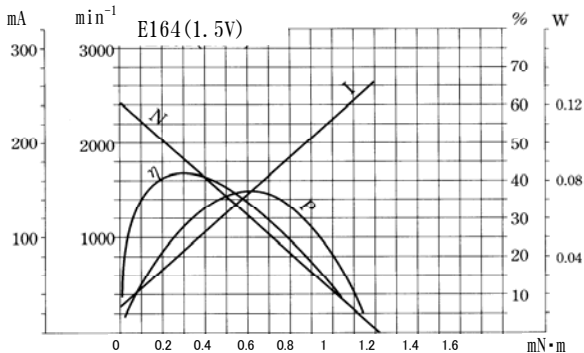
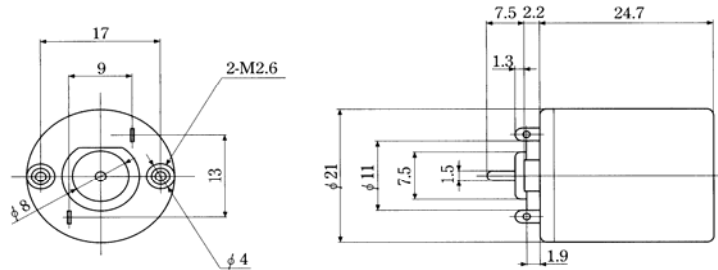

Model	Rated Voltage	No Load		Rated Load			CW
		Current	Speed	Load	Current	Speed	
	V _{DC}	mA	min ⁻¹	mN·m	mA	min ⁻¹	
E164	1.5	20	2400	0.2	60	2000	
E164	3.0	40	5100	1.0	250	2500	
E270	4.0	10	2650	0.2	25	2150	