

Model	Rated Voltage	No Load		Rated Load			ℓ	
		Current	Speed	Load	Current	Speed		
	V _{DC}	mA	min ⁻¹	mN·m	mA	min ⁻¹		
MK301	7.2	2500	18000	28.0	11000	16500	CCW 20.75	
MK417	12.0	400	5500	20.0	1500	4800	CCW 15.0	軸加工有
MK405	12.0	5000	31000	20.0	10000	28000	CCW 20.75	
MK503	22.5	200	4500	26.0	800	3700	CCW 20.75	20 ⁵ 穴なし
MK513	24.0	400	11200	20.0	1500	10400	CCW 15.0	

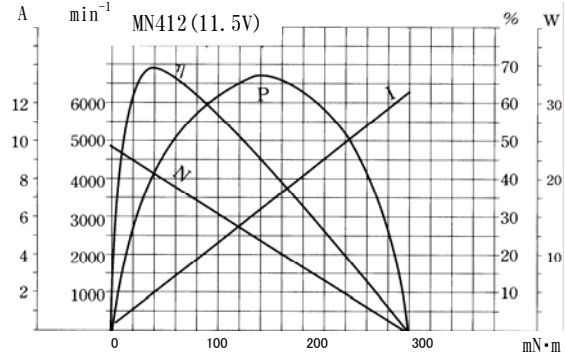

Model	Rated Voltage V _{DC}	No Load		Rated Load			
		Current mA	Speed min ⁻¹	Load mN·m	Current mA	Speed min ⁻¹	
MN401	9.6	2200	17000	30.0	8000	16000	CCW
MN404	12.0	380	4300	30.0	1550	3900	CCW
MN510	24.0	250	3350	80.0	1600	2550	CCW
MN509	24.0	230	4800	20.0	680	4600	CCW 20 ⁵ 穴なし
MN412	11.5	390	4850	52.0	2700	4000	CCW (軸長29.0)
↑ [MNタイプの特別仕様]							

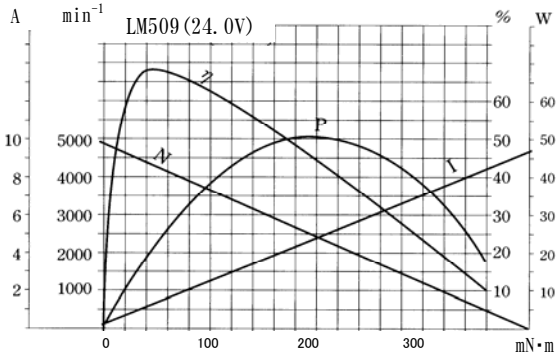
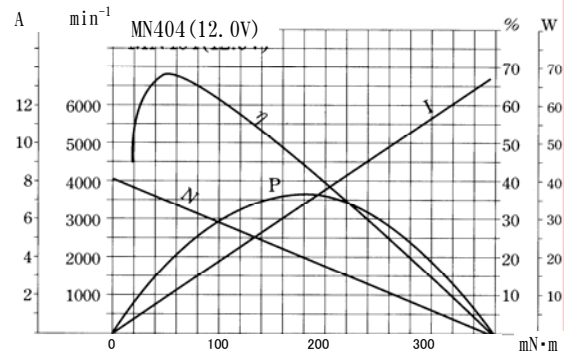
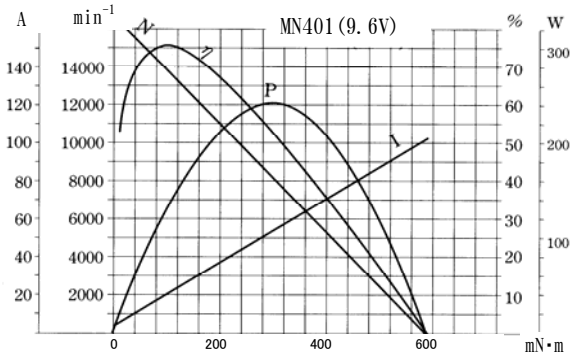
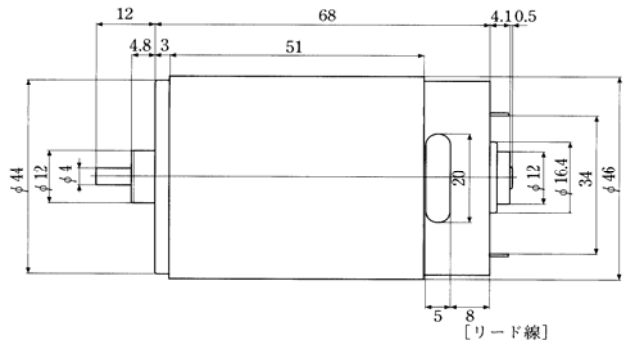
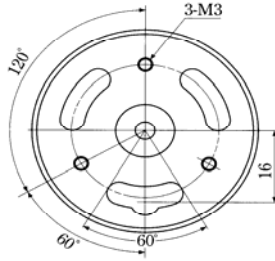
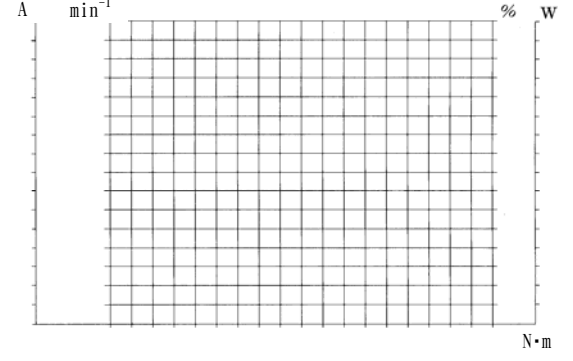
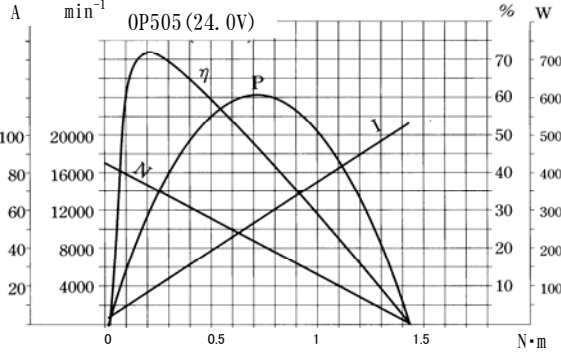
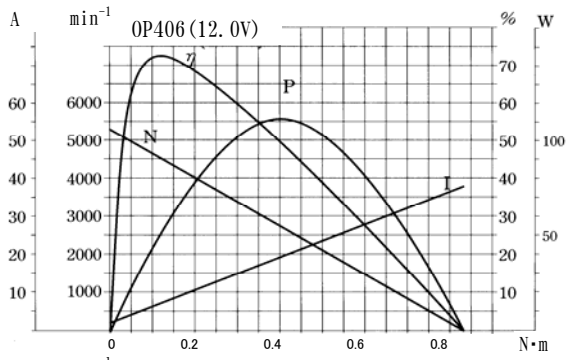
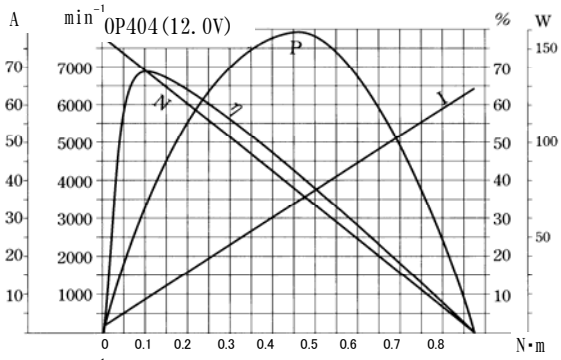
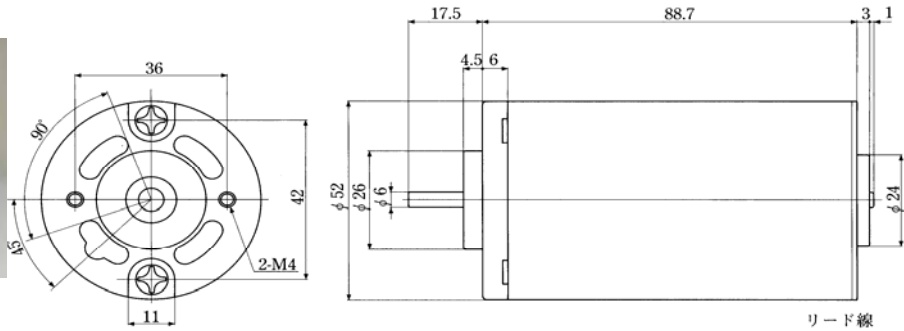

Model	Rated Voltage	No Load		Rated Load			
		Current	Speed	Load	Current	Speed	
	Vdc	mA	min ⁻¹	N·m	mA	min ⁻¹	
OP404	12.0	1400	7700	0.06	5800	7200	CCW
OP406	12.0	1000	5300	0.07	4000	4900	CCW
OP505	24.0	2000	16000	0.07	7000	15000	CCW
OP521	24.0	500	4900	0.10	2700	4100	CCW

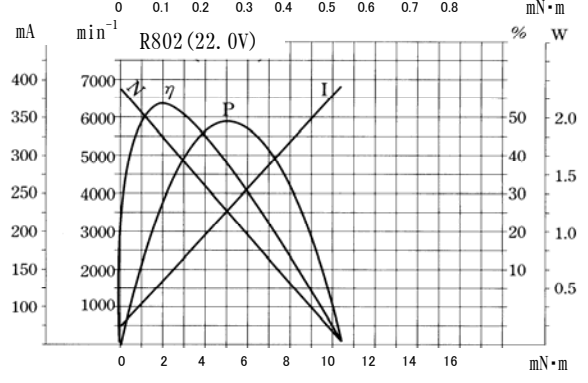
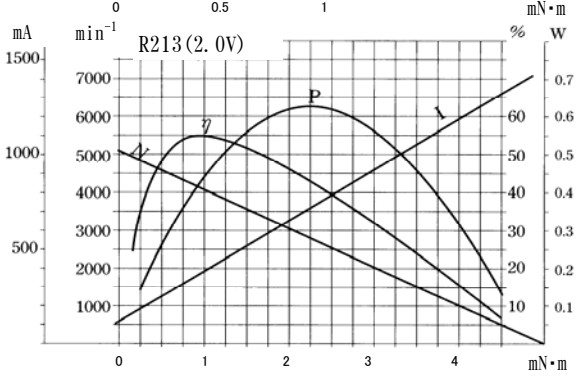
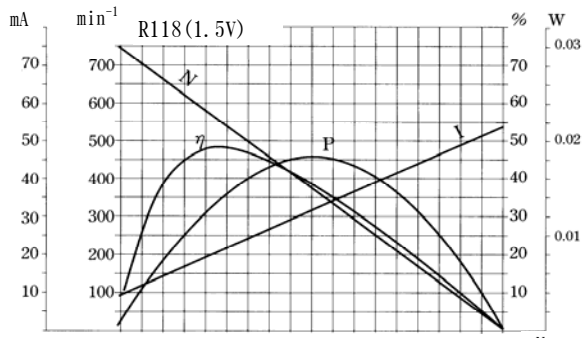
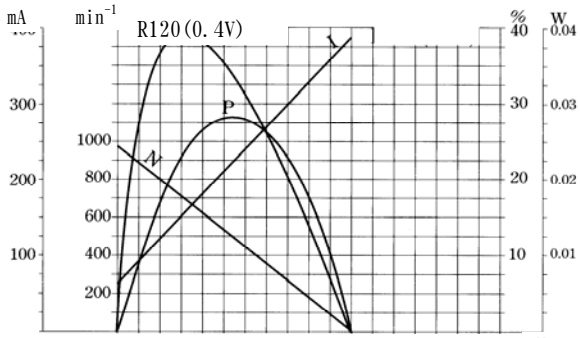
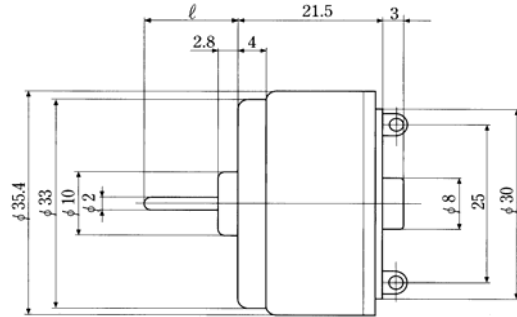
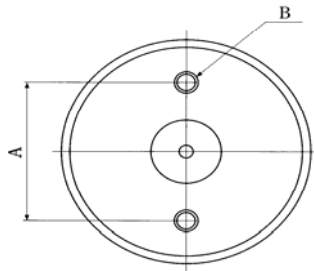

Model	Rated Voltage	No Load		Rated Load				ℓ	A B
		Current	Speed	Load	Current	Speed			
		mA	min ⁻¹	mN·m	mA	min ⁻¹			
R120	0.4	50	1000	0.1	80	900	CW	13.5	²² M2.6
R118	1.5	7	730	0.1	12	650	CW	13.3	²³ M3
R213	2.0	90	5000	1.0	350	3950	CW	8.8	²¹ M3
W802	22.0	26	6800	4.0	170	4200	CCW	7.2	タップ ナシ
↑ [Rタイプの特別仕様]									

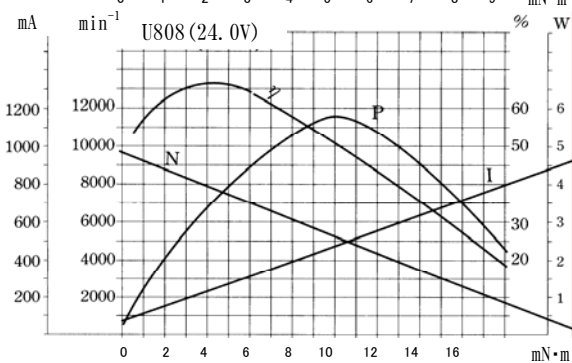
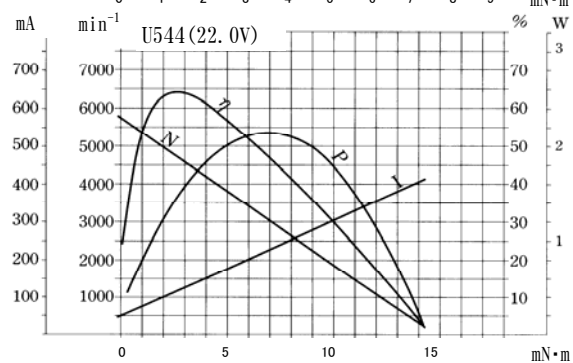
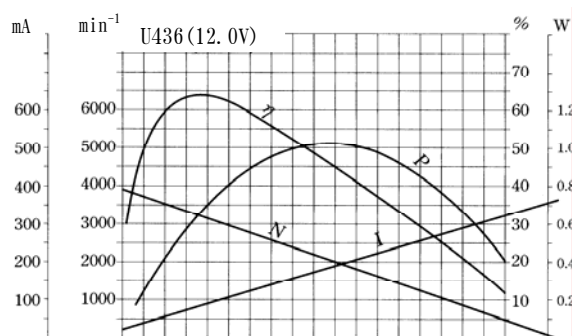
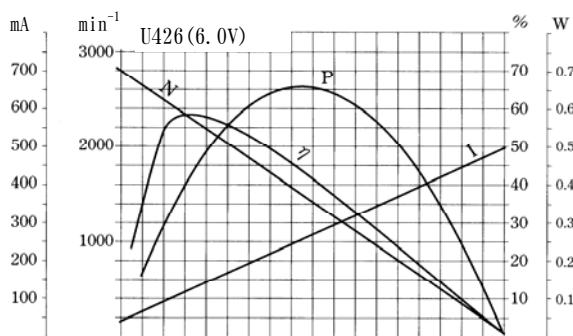
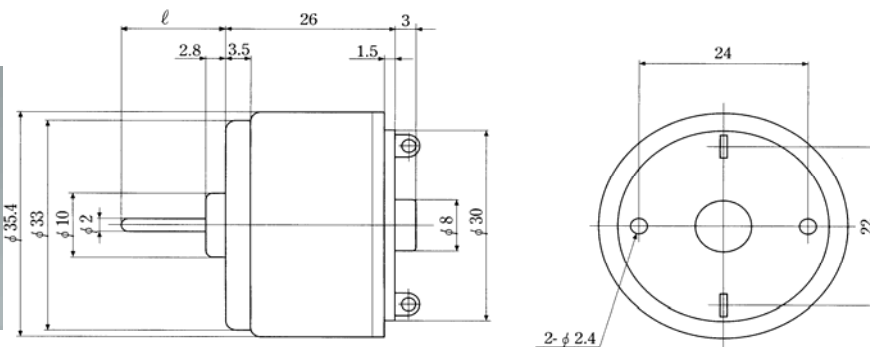

Model	Rated Voltage	No Load		Rated Load				ℓ	カップ仕様
		Current	Speed	Load	Current	Speed			
	V _{DC}	mA	min ⁻¹	mN·m	mA	min ⁻¹			
U 357	4.5	22	2200	1.0	72	1850	CW	12.8	²⁶ M2.6
U 426	6.0	34	2800	1.0	85	2500	CW	12.8	²³ M3
U 436	12.0	15	4000	1.0	48	3600	CW	8.8	²⁶ M2.6
U 546	20.0	10	3000	2.5	50	2200	CW	6.6	
U 544	22.0	20	5600	4.0	125	4100	CCW	8.8	
U 808	24.0	35	9400	3.0	150	8100	CW	12.8	

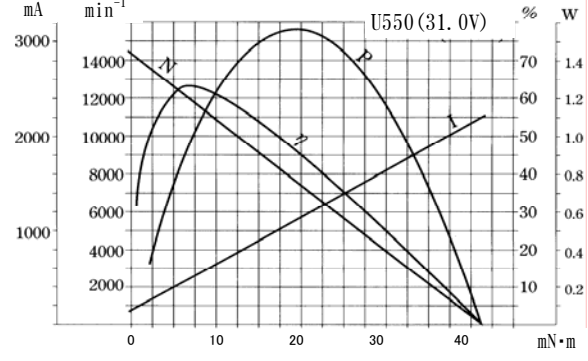
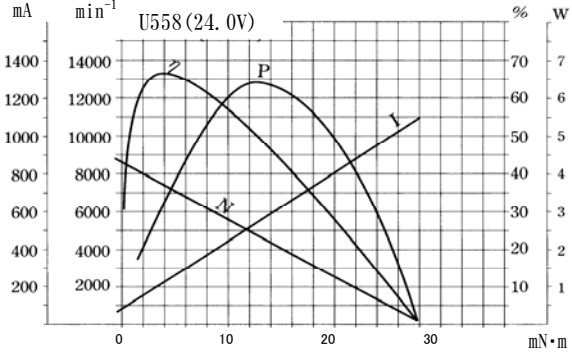
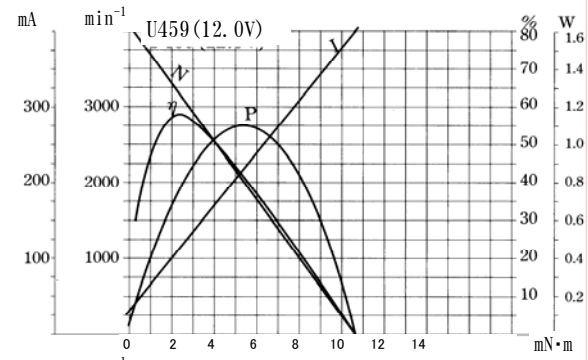
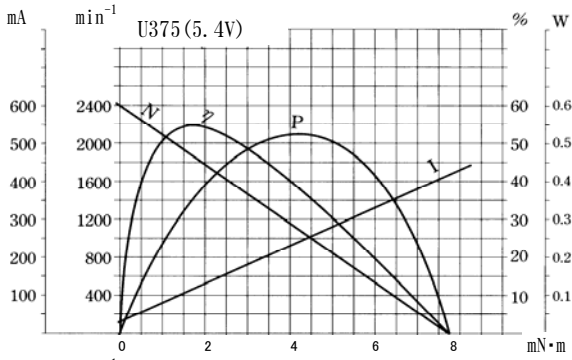
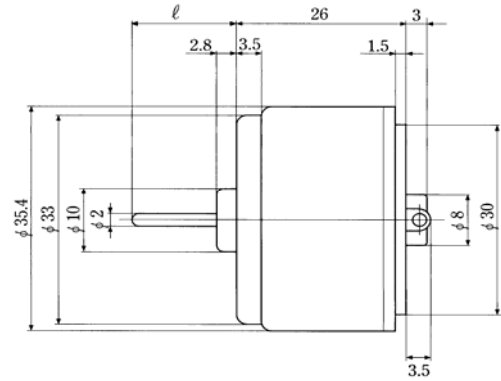
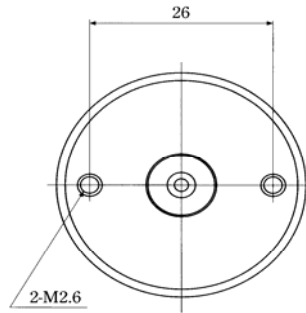

Model	Rated Voltage	No Load		Rated Load			CW/CCW	ℓ
		Current	Speed	Load	Current	Speed		
	V _{dc}	mA	min ⁻¹	mN·m	mA	min ⁻¹		
U 375	5.4	32	2400	1.0	82	2100	CW	8.8
U 459	12.0	24	4000	1.0	58	3600	CW	8.8
U 539	22.0	26	5600	4.0	130	4100	CCW	12.8 タップ°ナシ
U 558	24.0	45	9200	3.0	160	7900	CCW	12.8 タップ°ナシ
U 550	31.0	85	14600	3.5	270	13500	CCW	12.8

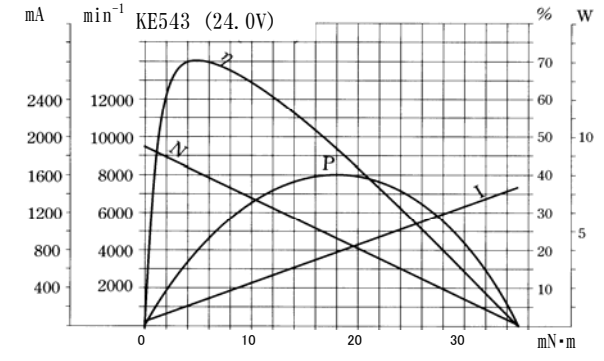
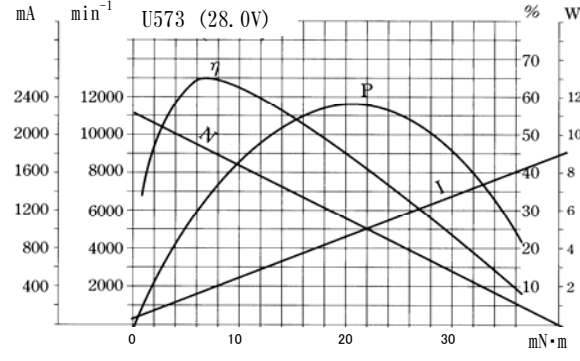
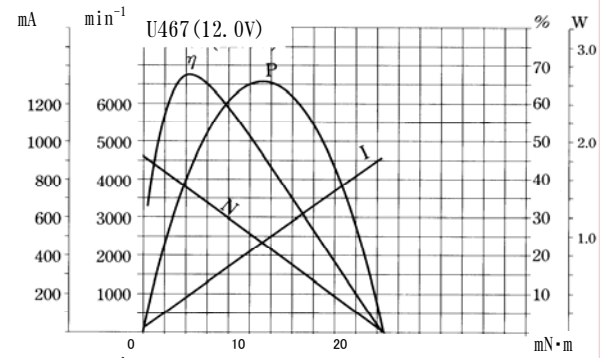
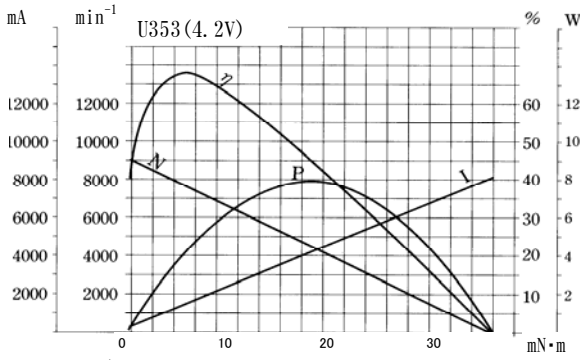
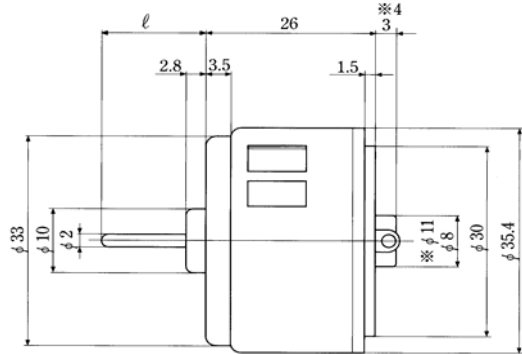
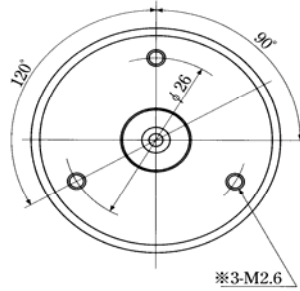

Model	Rated Voltage	No Load		Rated Load			タップ仕様			
		Current	Speed	Load	Current	Speed	ℓ	A	B	
	Vdc	mA	min ⁻¹	mN·m	mA	min ⁻¹				
U353	4.2	230	9200	4.0	1150	8100	CW	19.0	23	2-M3
U369	6.0	140	7000	4.0	640	6300	CCW	11.3	26	2-M2.6
U467	12.0	40	4600	3.5	210	3900	CCW	12.8	26	2-M2.6
U573	28.0	75	11000	7.0	350	9100	CCW	7.9	26	3-M2.6※
KE543	24.0	60	9800	5.0	250	8200	CCW	7.9	26	3-M2.6※
KE544	24.0	30	4000	2.5	60	3400	CCW	7.9	26	3-M2.6※

TYPE **GFH**



TYPE **GKE**



TYPE **GLJ**

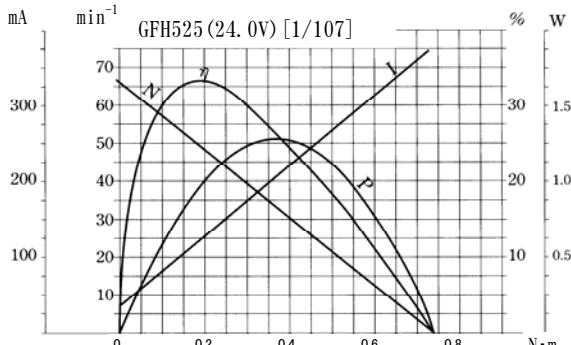

※ Modelナンバーは、仕様（電圧及ギヤ比）により異なります。

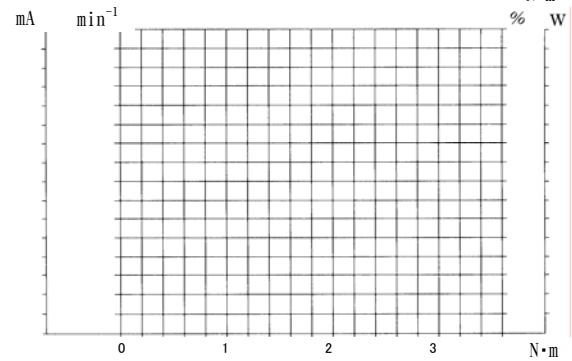
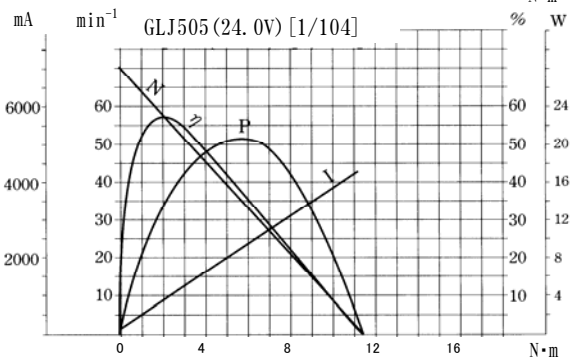
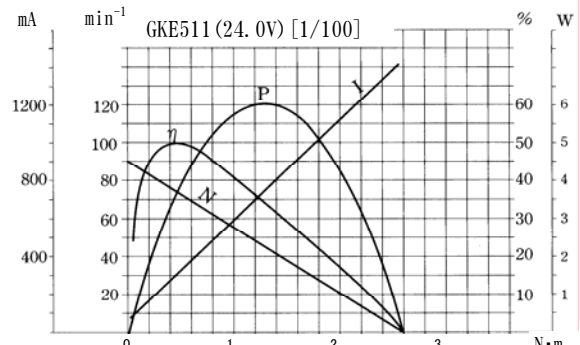

Model	Rated Voltage	No Load		Rated Load			軸径	外形	全長	
		Current	Speed	Load	Current	Speed				
	Vdc	mA	min ⁻¹	N·m	mA	min ⁻¹				
GFH525	24.0	35	67	0.1	80	58	CW	φ 3	φ 22	70
GKE511	24.0	60	90	0.3	230	80	CW	φ 6	φ 37	75
GLJ505	24.0	170	70	1.2	600	62	CW	φ 8	φ 43	113